

# Pad Site at 2351 Vintage Drive

Excelsior Springs, MO 64024

## Land For Sale



### Property Info

- 0.84 acres pad site adjacent to Aldi at signalized intersection of Hwy 69 and S. McCleary Road
- Over 17,600 VPD along Hwy 69
- Nearby Tenants include Walmart, Dollar Tree, McDonalds, Applebees, GO Car Wash, Waffle House, and more.
- Zoning: C-3 (Service Business District)
- Positioned across the street from Walmart, which has over 2M visits annually and pulls from nearby communities such as Kearney and Lawson.
- Asking Price: \$575,000

2023 Demographics	1 Mile	3 Miles	5 Miles
Population Density	1,850	11,549	18,277
Households	705	4,451	6,915
Average Household Income	\$77,257	\$66,910	\$77,450



# Pad Site at 2351 Vintage Drive, Excelsior Springs, MO



★ Apr 1st, 2023 - Mar 31st, 2024  
Data provided by Placer Labs Inc. ([www.placer.ai](http://www.placer.ai))

# Pad Site at 2351 Vintage Drive, Excelsior Springs, MO

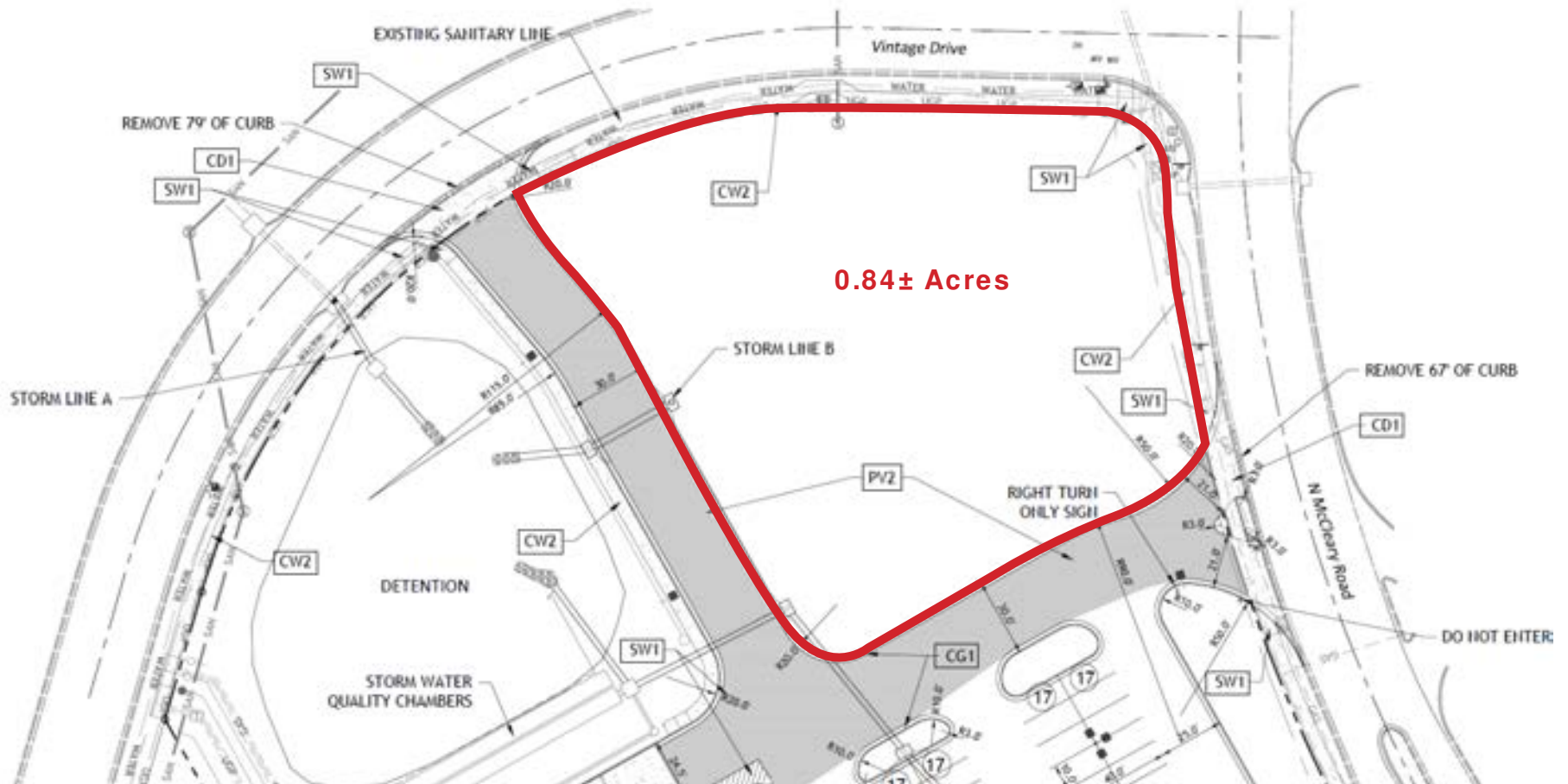

**David Hickman**  
david@vadllc.com  
Office: 913-491-8900  
Mobile: 816-898-8531

Disclaimer: The information provided herein is believed to be reliable, but we cannot guarantee its accuracy or completeness. We have not independently verified the information, and make no warranty, representation, or guarantee, either expressed or implied, as to its reliability, suitability, or availability. Any projections, opinions, assumptions, or estimates provided are for illustrative purposes only and do not necessarily reflect the current or future performance of the property. It is recommended that you and your advisors conduct an independent investigation of the property to ensure it meets your needs. Any photos and logos featured are the property of their respective owners, and their unauthorized use is prohibited.